



Premises location - Wellers Hill Arts Hub, 140 Weller Rd, Tarragindi, 4121

Top Floor or Ground floor RENTAL CONDITIONS FOR CASUAL HIRERS

2019

Non BVAC member Top Floor (Air conditioned) \$20 per hour, 1/2 day \$70 full day \$130.

Non BVAC members Ground floor \$20 per hour, 1/2 Day \$60, Full day \$120.

ABN: 80 240 724 133

Etching Press room hire \$5 per hour flat rate. (Conditions apply)

Key deposit \$20. Refundable upon return of keys.

Hirers to arrange opening of premises with BVAC liaison officer and at end of hire drop keys in lock box in downstairs door and close gate upon leaving.

BRISBANE VISUAL ARTS  
COMMUNITY  
PO Box 7098  
HOLLAND PARK EAST  
QLD 4121

WE ASK THAT THE FLOORS BE SWEEPED. KITCHEN AND TOILET AREAS BE CLEAN AND TIDY AND RUBBISH REMOVED AFTER EACH HIRE. ANY EQUIPMENT USED PUT BACK IN STORAGE.

NO ALCOHOL PERMITTED ON THE PREMISES. NON SMOKING PREMISES.

PLEASE ENSURE ALL DOORS ARE LOCKED AND LIGHTS TURNED OFF.

CAR PARK GATE TO BE CLOSED UPON LEAVING.

IF THE ABOVE CONDITIONS ARE NOT ADHERED TO HIRE WILL BE TERMINATED.

Contact Details

Www.bvac.org.au

Facebook—BVAConlineHub

Building liaison Officer—

Sandra Evans 0409498768

bvac2015@gmail.com

I hereby acknowledge that as the hirer I will abide by the rules stated above.

Name ..... Contact details PH.....

Hire dates..... Email:.....

Signed By Hirer..... Dated ...../...../.....

BVAC officer.....

**IN CASE OF FIRE**

- R**EMOVE PEOPLE from immediate danger
- A**LERT THE FIRE SERVICE
  - break manual call point
  - call 000
- C**ONFINE FIRE & SMOKE close doors and windows (if safe to do so)
- E**VACUATE to the ASSEMBLY AREA



Mobility impaired persons should evacuate immediately on hearing the fire alarm assisted by a nominated person.

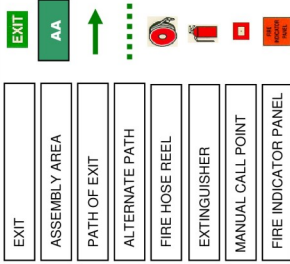

**EVACUATION SIGN and DIAGRAM**  
Weller Hill Hub  
Ground Floor Plan

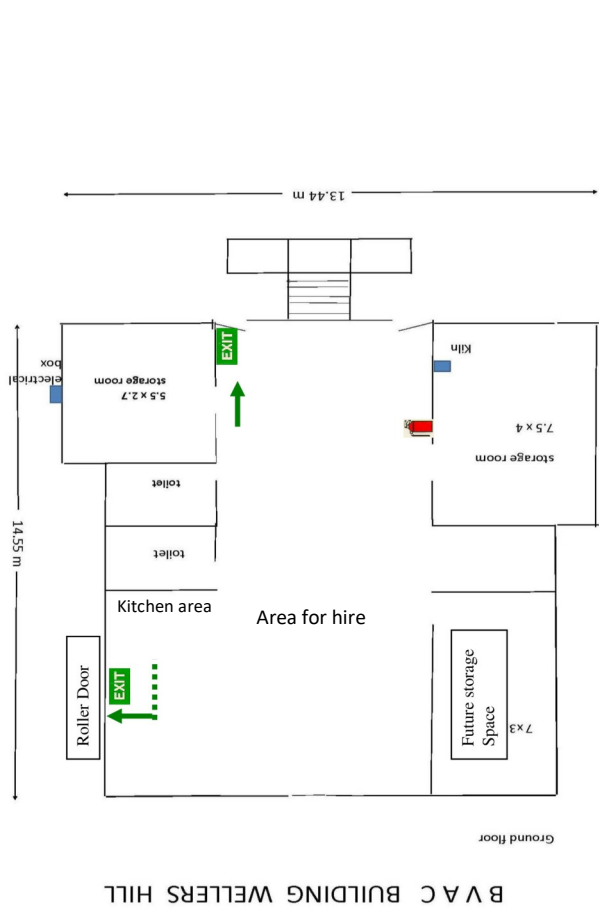

**EVACUATION SIGN and DIAGRAM**  
Wellers Hill Hub  
First Floor Plan



**IN CASE OF FIRE**

- R**EMOVE PEOPLE from immediate danger
- A**LERT THE FIRE SERVICE
  - break manual call point
  - call 000
- C**ONFINE FIRE & SMOKE close doors and windows (if safe to do so)
- E**VACUATE to the ASSEMBLY AREA



Mobility impaired persons should evacuate immediately on hearing the fire alarm assisted by a nominated person.

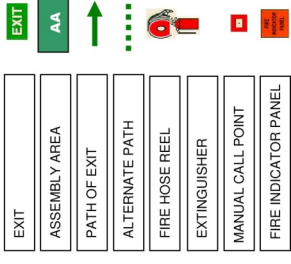

No disability access to the First floor.