



Premises location - Wellers Hill Arts Hub, 140 Weller Rd, Tarragindi, 4121

Top Floor or Ground floor RENTAL CONDITIONS FOR CASUAL HIRERS

2019

BVAC Member Top Floor (Air conditioned) \$15 per hour, 1/2 day \$50, full day \$90

BVAC Member Ground floor \$15 per hour, 1/2 day \$40, Full day \$75.

Etching Press room hire \$5 per hour flat rate. (Conditions apply)

ABN: 80 240 724 133

WE ASK THAT THE FLOORS BE SWEEPED. KITCHEN AND TOILET AREAS BE CLEAN AND TIDY AND RUBBISH

REMOVED AFTER EACH HIRE. ANY EQUIPMENT USED PUT BACK IN STORAGE.

**NO ALCOHOL PERMITTED ON THE PREMISES. NON SMOKING PREMISES.**

**PLEASE ENSURE ALL DOORS ARE LOCKED AND LIGHTS TURNED OFF.**

**CAR PARK GATE TO BE CLOSED UPON LEAVING.**

IF THE ABOVE CONDITIONS ARE NOT ADHERED TO HIRE WILL BE TERMINATED.

**I hereby acknowledge that as the hirer I will abide by the rules stated above.**

BRISBANE VISUAL ARTS  
COMMUNITY  
PO Box 7098  
HOLLAND PARK EAST  
QLD 4121

Contact Details

Www.bvac.org.au

Facebook—BVAConlineHub

Building liaison Officer—  
Sandra Evans 0409498768

bvac2015@gmail.com

**Organisation .....**

**Name ..... Contact details PH.....**

**Email:.....**

**Signed By Hirer..... Dated ...../...../.....**

**BVAC officer.....**

**IN CASE OF FIRE**

- R**EMOVE PEOPLE from immediate danger
- A**LERT THE FIRE SERVICE
  - break manual call point
  - call 000
- C**ONFINE FIRE & SMOKE close doors and windows (if safe to do so)
- E**VACUATE to the ASSEMBLY AREA



Mobility impaired persons should evacuate immediately on hearing the fire alarm assisted by a nominated person.

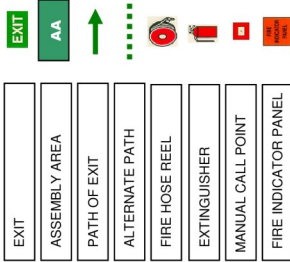

**EVACUATION SIGN and DIAGRAM**  
Weller Hill Hub  
**Ground Floor Plan**

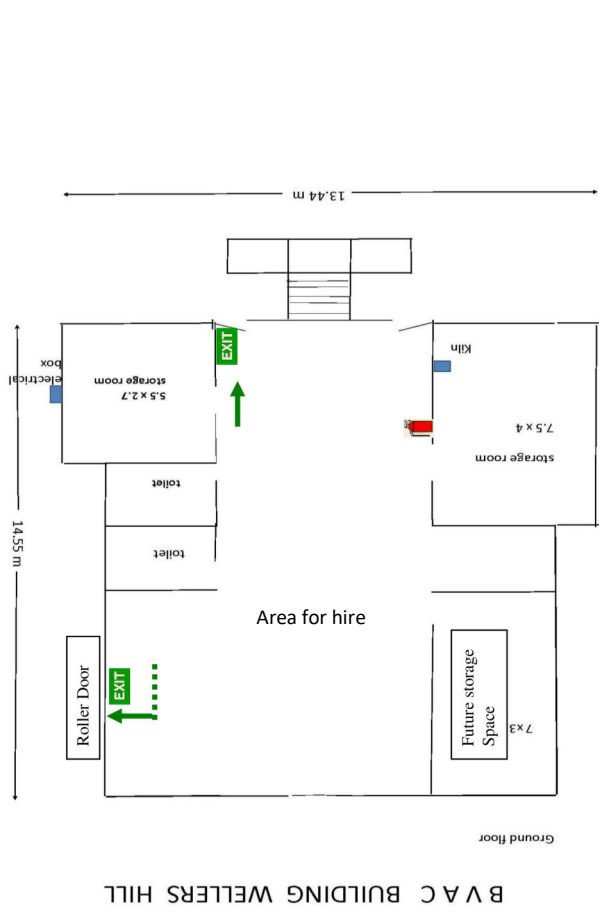

**EVACUATION SIGN and DIAGRAM**  
Wellers Hill Hub  
**First Floor Plan**



**IN CASE OF FIRE**

- R**EMOVE PEOPLE from immediate danger
- A**LERT THE FIRE SERVICE
  - break manual call point
  - call 000
- C**ONFINE FIRE & SMOKE close doors and windows (if safe to do so)
- E**VACUATE to the ASSEMBLY AREA



Mobility impaired persons should evacuate immediately on hearing the fire alarm assisted by a nominated person.

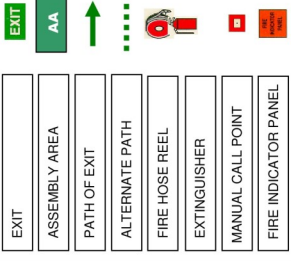

No disability access to the First floor.

**List of contents of Storage room/s**

Non—Flammable items

Flammable items

List of Members with Keys