



Premises location - Wellers Hill Arts Hub, 140 Weller Rd, Tarragindi, 4121

Top Floor or Ground floor RENTAL CONDITIONS FOR CASUAL HIRERS

BVAC Member Top Floor (Air conditioned) \$15 per hour, 1/2 day \$50, full day \$90

Non BVAC member Top Floor (Air conditioned) \$20 per hour, 1/2 day \$70 full day \$130.

BVAC Member Ground floor \$15 per hour, 1/2 day \$40, Full day \$75.

Non BVAC members Ground floor \$20 per hour, 1/2 Day \$60, Full day \$120.

Etching Press room hire \$5 per hour flat rate. (Conditions apply)

Key deposit \$20. Refundable upon return of keys.

Hirers to arrange opening of premises with BVAC liaison officer and at end of hire drop keys in lock box in downstairs door and close gate upon leaving.

WE ASK THAT THE FLOORS BE SWEEPED. KITCHEN AND TOILET AREAS BE CLEAN AND TIDY AND RUBBISH REMOVED AFTER EACH HIRE. ANY EQUIPMENT USED PUT BACK IN STORAGE.

NO ALCOHOL PERMITTED ON THE PREMISES. NON SMOKING PREMISES.

PLEASE ENSURE ALL DOORS ARE LOCKED AND LIGHTS TURNED OFF.

CAR PARK GATE TO BE CLOSED UPON LEAVING.

IF THE ABOVE CONDITIONS ARE NOT ADHERED TO HIRE WILL BE TERMINATED.

I hereby acknowledge that as the hirer I will abide by the rules stated above.

ABN: 80 240 724 133

BRISBANE VISUAL ARTS
COMMUNITY
PO Box 7098
HOLLAND PARK EAST
QLD 4121

Contact Details

Www.bvac.org.au

Facebook—BVAConlineHub

Building liaison Officer—

Sandra Evans 0409498768

bvac2015@gmail.com

Name Contact details PH.....

Hire dates..... Email:.....

Signed By Hirer..... Dated/...../.....

BVAC officer.....

IN CASE OF FIRE

- R**EMOVE PEOPLE from immediate danger
- A**LERT THE FIRE SERVICE
 - break manual call point
 - call 000
- C**ONFINE FIRE & SMOKE close doors and windows (if safe to do so)
- E**VACUATE to the ASSEMBLY AREA



Mobility impaired persons should evacuate immediately on hearing the fire alarm assisted by a nominated person.

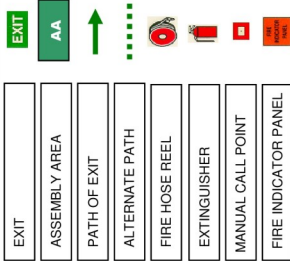

EVACUATION SIGN and DIAGRAM
Weller Hill Hub
Ground Floor Plan

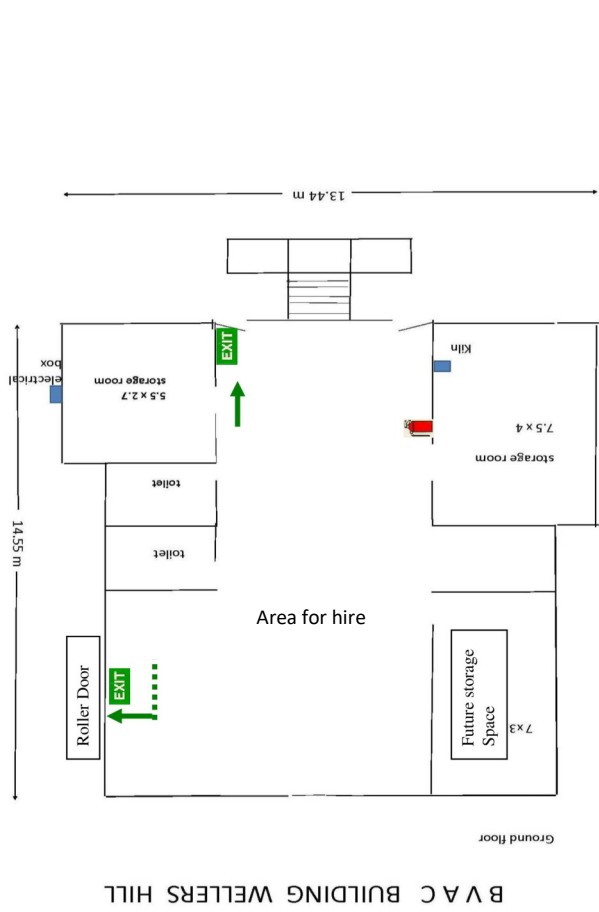

EVACUATION SIGN and DIAGRAM
Wellers Hill Hub
First Floor Plan



IN CASE OF FIRE

- R**EMOVE PEOPLE from immediate danger
- A**LERT THE FIRE SERVICE
 - break manual call point
 - call 000
- C**ONFINE FIRE & SMOKE close doors and windows (if safe to do so)
- E**VACUATE to the ASSEMBLY AREA



Mobility impaired persons should evacuate immediately on hearing the fire alarm assisted by a nominated person.

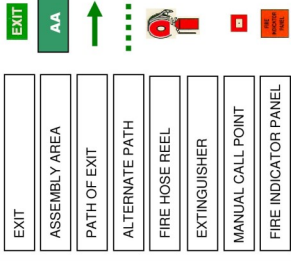

No disability access to the First floor.